

SITE PLAN SHOWING LATITUDE & LONGITUDE FOR PROPOSED  
 G+III STORIED(HT.-12.500MT.) RESIDENTIAL  
 BUILDING AT- 46/2, SRI RAM THAKUR ROAD,(FORMALY KNOWN AS JADAVPUR  
 CENTRAL ROAD) KOLKATA- 700032,  
 WARD NO.-96, BOROUGH NO.-X, P.S.- JADAVPUR.

POINT MARK	LATITUDE (N)	LONGITUDE (E)	SITE ELEVATION (AMSL) (MTR)
A	22°29'46.4"N	88°21'59.9"E	6.0
B	22°29'46.4"N	88°21'59.3"E	6.0
C	22°29'45.8"N	88°21'59.3"E	6.0
D	22°29'45.7"N	88°21'59.7"E	6.0

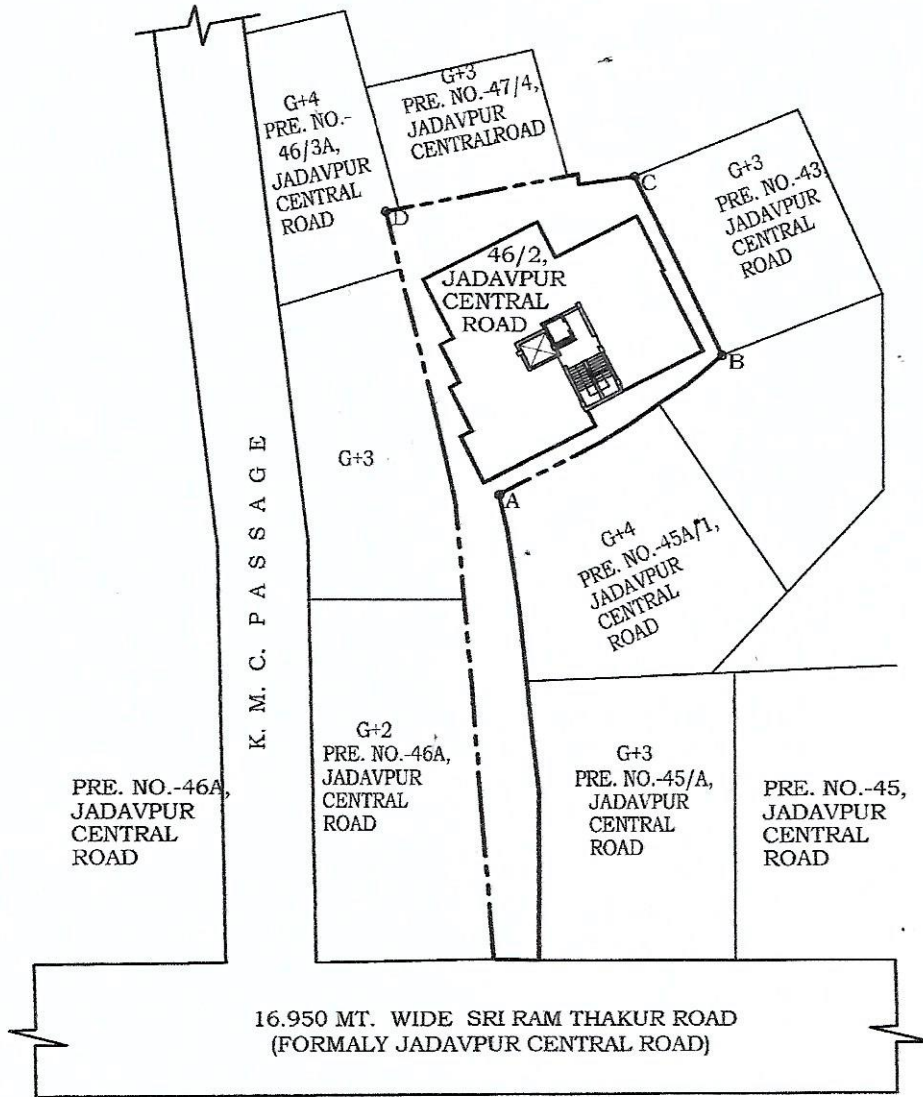

SITE PLAN  
SCALE-1:600



ASR PROJECTS AND VENTURES LLP

*[Handwritten Signature]*  
 Authorised Signatory

SIGNATURE OF ARCHITECT

SIGNATURE OF OWNER